

Product data sheet

Plus

AR885L



ARRONE lever operated outside access device:

- Function: lever and key operation
- Body material: zinc
- Lever material: aluminium
- Maximum door weight: 200 kg
- Options: device without cylinder (AR8806L)
- Testing: included as part of both single and double door sets in accordance with the requirements of **BS EN 1125:2008** and **BS EN 179:2008, BS EN 1634-1**. Assessed for use on 30 and 60 minute timber fire doors.
- Included as an accessory on CE certificate AAA005, ABB015, UKCA certificate UK-AAA7651 and UK-ABB7654
- Included as an accessory on Certifire certificate CF810 and DOP HUK0022, HUK0023, HUK0022-UK, HUK0023-UK

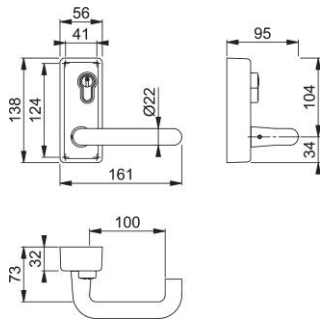

Article number	50015606
Product ref.	AR885L-SE
EAN-Code	5051358007703
Country of origin	United Kingdom
CN-Code	83024110
Material	
Spindle size	8 mm
Spindle length	
Door type	Metal door
Number of pins	5
Pinning and Keying	5 pin
Fixings	Metal door
Function	
Material Body	zinc
Shape	Lever shape: return to door
Finish	SE Silver Enamel
Cylinder finish	SNP satin nickel plated
Range	ARRONE Range
Packing unit	0
Outer carton	0