

# Product data sheet

**duraplus**<sup>®</sup>

42FIS



HOPPE aluminium escutcheon with turn for entrance doors (interior side):

- Bearing: fixed/movable turn
- Connection: for 5 mm diagonal or 8 mm flat spindle
- Base: nylon
- Fixing: concealed, from inside, M5 thread screws that can be shortened

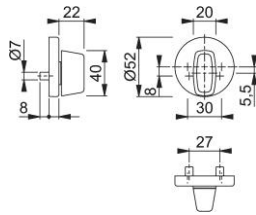

|                      |                                    |
|----------------------|------------------------------------|
| Article number       | 810741                             |
| EAN-Code             | 4012789068153                      |
| Country of origin    | Italy                              |
| CN-Code              | 83024110                           |
| Door thickness       |                                    |
| Spindle size privacy | 5 mm diagonal or 8 mm flat spindle |
| (Key)Hole size       | turn                               |
| Screws               | M5x90 mm to be shortened           |
| Finish               | F9 aluminium steel effect          |
| Range                | Supplementary products             |
| Packing unit         | 50                                 |
| Outer carton         | 50                                 |