

Product data sheet

Plus

AR8103



ARRONE mortice deadlock case:

- Function: Latch bolt and deadbolt operation
- Deadbolt projection: 15 mm, single throw
- Forend/strike material: Stainless steel
- Forend type: Double
- CE Marked: AG0087, UKCA Marked: AG7670
- - **BS EN 12209**: 3 | M | 8 | 1* | 0 | G | - | B | 0 | 2 | 0
- Certifire approved: CF5022, CE DOP: HUK0033, UKCA DOP: HUK0033-UK
- Testing: **BS EN 1634-1**. Assessed for use on 30, 60, 90 and 120 minute timber fire doors and 240 minutes steel fire doors.
- Meets dimensional recommendations of **BS 8300** and ADM for locks
- * The AR8103 series lock case has been successfully fire tested with the use of an intumescent kit. The supply and fitting of this intumescent kit is essential to the products compliance with the fire test and CE marking evidence it has gained. HOPPE takes no responsibility for any locks purchased and fitted without sufficient intumescent protection.

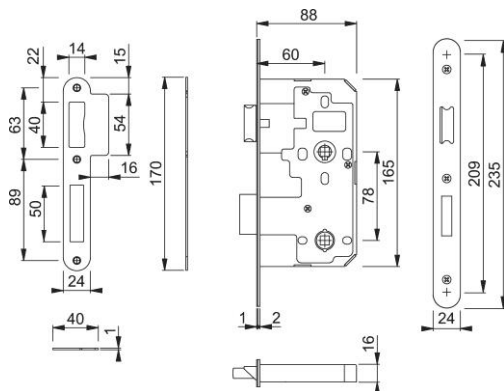

Article number	87134392
Product ref.	AR8103-R-60-SSS
EAN-Code	5051358066199
Country of origin	Portugal
CN-Code	83014019
Operation	Half Lever Set
Follower	8 mm
Backset	60 mm, pierced for furniture and es-cutcheons at 38 mm centres
(Key)Hole size	Euro profile cylinder
Key hole distance	78 mm
Door type	
Fixings	2 x 4,0x25 pz A2, 3 x 3,5x20 pz A2, 2 x M4x6,0 DIN 965 pz A2, 1 x M4x10,0 DIN 965 pz A2
Corner	radius corners
Shape	radiused
Finish	F69 satin stainless steel
Face plate finish	F69 satin stainless steel
Range	ARRONE Range
Packing unit	1
Outer carton	25